

Tamper Proof Manual Control Point (MCP)



Features

The Tamper Proof MCP is designed to eliminate nuisance activation of the smoke ventilation system whilst delivering the full functionality required of an MCP.

Fully complies to prEN12101 part 9.

The orange (RAL 2011) MCP displays system and vent status visibly through three LEDs, "power, fault and activated" as required by the standard.



Application

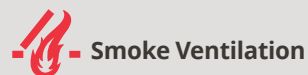

Technical Drawing

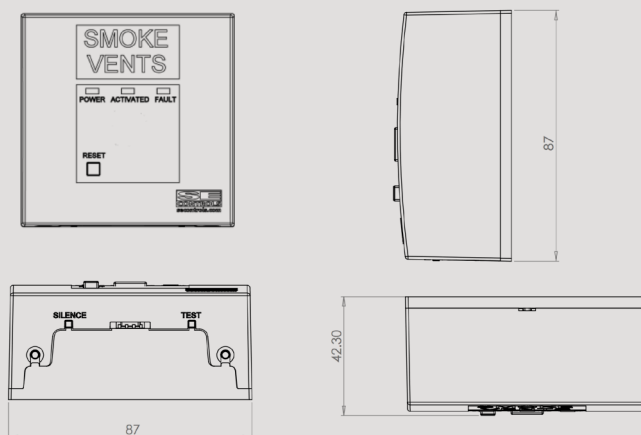

All dimensions in millimetres
The AutoCAD drawing for this product can be found at www.secontrols.com

OSLoop Control System

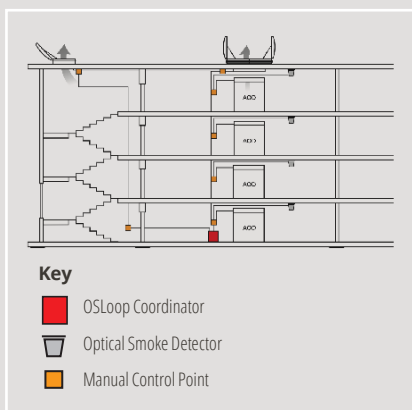

OS2 Control System

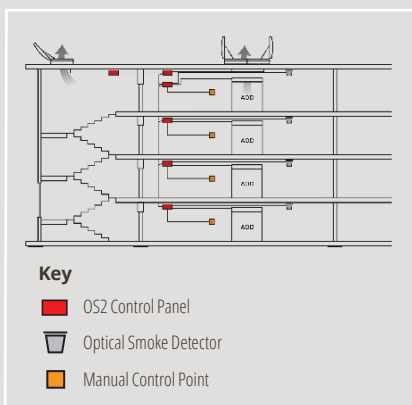

Technical Data

Device details

Tested prEN12101-9
Provided in orange (RAL 2011) as required as part of prEN12101-9
The device has the capabilities of providing audible signals and faults along with having a silence button out of view
The device continuously monitors actuators and connections to smoke detectors (As required by prEN12101-9)
Maintenance indication (Statutory requirement of the Regulatory Reform Order (Fire Safety))
Activation via access key fob
Reset via access key fob
Reset push button
Activated LED
Power/Healthy LED
Fault LED

For use with 24 V OSLoop and OS2 control panels.

87 x 87 x 22 mm (h x w x d) - Flush mount
87 x 87 x 54 mm (h x w x d) - Surface mount

MCP Part Numbers

OSLoop MCP part numbers	Complete Assembly	FCS00300028
	MCP Module Assembly	FCS00300020
	Adapter Plate Assembly	FCS00300018
OS2 MCP part numbers	Complete Assembly	FCS00200081
	MCP Module Assembly	FCS00200037
	Adapter Plate Assembly	FCS00200017
Miscellaneous Item Part Numbers	Dumb Reset Key	FCS00200024
	MCP Activation Key	FCS00200033
	Surface Mounting Box	FYS15040061