

# AT31

Linear Multi-Point Locking Actuator / 24 V / 1 A DC / 600 N



## AT31 Linear Multi-Point Locking Actuator / 24 V / 1 A dc / 600 N

The AT31 has been developed to provide reliable and secure window locking in environmental ventilation.

SE Controls manufacture this high-quality 'Made in Britain' actuator with the following features:

- Seamless two way communication with Building Management Systems via Modbus protocol
- Simple 2 wire open/close 24 V operation for non-BMS applications
- Standard finish is RAL 7016 (Anthracite Grey) but it can be customised to suit installation requirements
- Current draw is 1 A max at 600 N
- Quiet operation with stroke 1-22 mm (configurable)
- Low friction and high torque for consistent and smooth power delivery
- Programmable average opening and closing speed
- Synchronised operation with AT12 Single and Twin Actuators
- Programmable functionality: opening and closing speed, seal relief, stroke
- Inbuilt cycle counting to provide operational frequency to protect warranty
- Product Warranty: 15,000 operational cycles or 12 months<sup>1</sup>

<sup>1</sup> Commercial terms for each project will supersede this warranty information.



Applications



Environmental Ventilation

## Technical Drawing

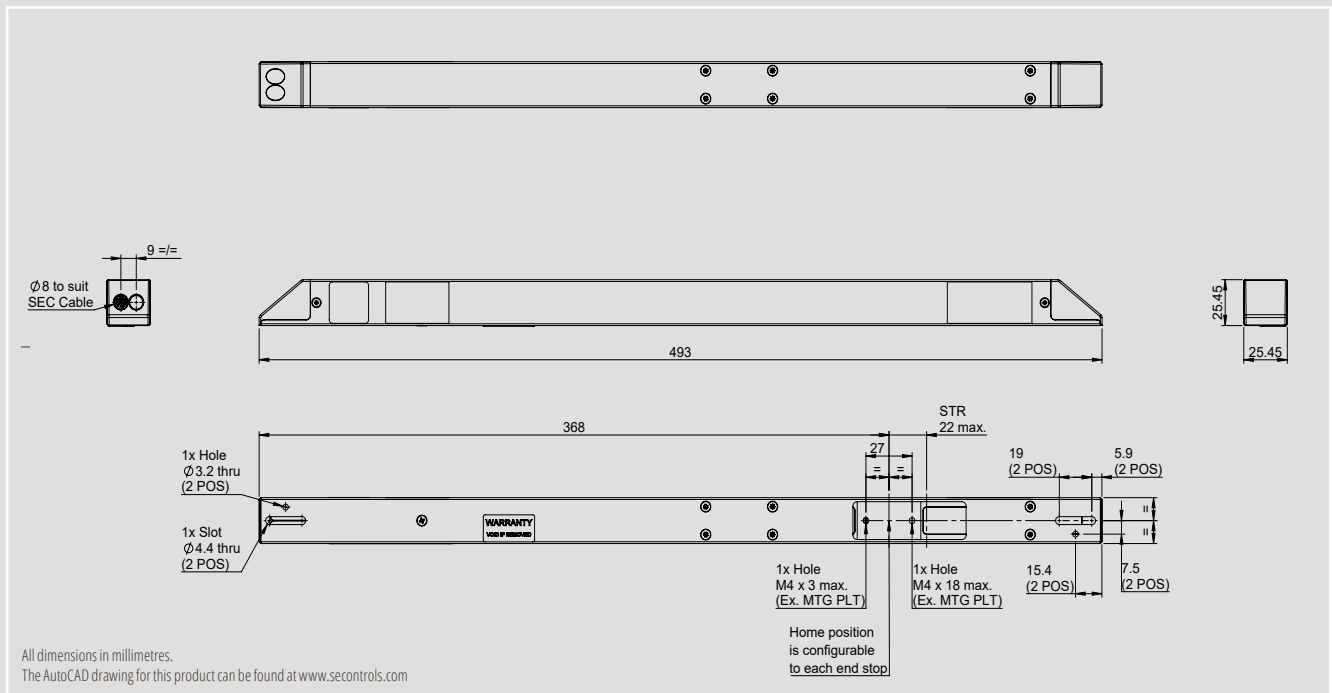

## Cross Section

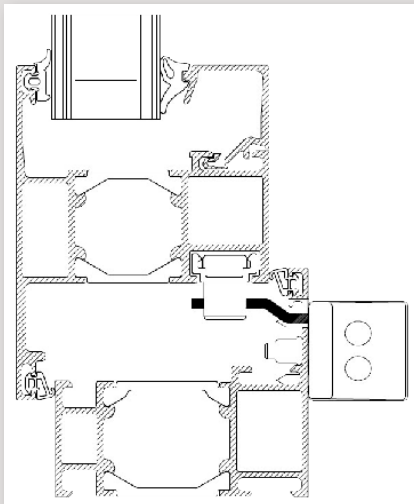

**NB: 24 V actuators require control from a compatible low voltage unit such as an OS2 SHEVTEC controller or NVLogIQ PSU and permanent power should not be applied.**

Please ensure the controllers have a minimum 1 second delay between switching and a permissible ripple voltage of 1Vs if they are not SE Controls products.

## Technical Data

Actuator Designation	AT31
Actuator Type	24 V Linear Multi-Point Locking Actuator
Voltage (all +/-5%)	24 V
Current Draw (Amp)	1 A max dc at 600 N
Stroke	1-22 mm (configurable) (18mm default)
Operating Speed	2.5 mm/s (configurable)
Ambient Operating Temp	-5°C to +60°C
IP Rating	IP42
Thrust Force	600 N max
Close Force	600 N max
Switching	Electronic
Standard Finish Powder coated	RAL 7016 (Anthracite Grey) RAL 9005 (Jet Black) RAL 9006 (White Aluminium) RAL 9010 (Pure White)
Colour Option	Other colours available on request
Flex Length	3 m
Flex Type	4 core silicone
Flex Colour	Grey or White <sup>1</sup>
Duty Cycle	30% (3 minutes on, 7 minutes off)
Product Warranty	15,000 cycles or 12 months from the date of invoice <sup>2</sup>
Drive Forks	Please contact Facade Technical for further details
Application	Environmental Ventilation

<sup>1</sup> This information is provided as guidance as raw materials and manufacturing processes differ therefore we cannot guarantee a precise match with the actuator body colour.  
<sup>2</sup> Commercial terms for each project will supersede this warranty information.

## Product Code

AT31 Locking Catch 18 mm RAL 7016 Matt 600 N 24 V Surface	A31S0160020
---	-------------